

eureka

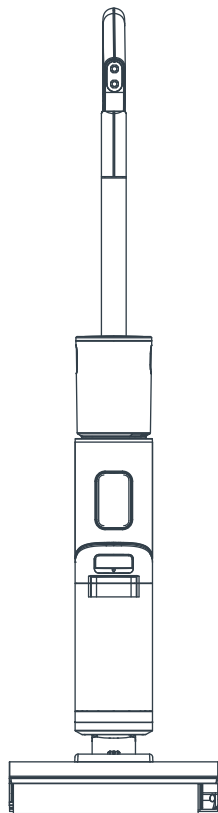

INSTRUCTION MANUAL

NEW430BL

FLOOR CLEANER

Please read the manual before use.

CONTENTS

SAFETY INSTRUCTIONS	03
PRODUCT OVERVIEW	06
PRODUCT INSTALLATION	08
OPERATION INSTRUCTIONS	10
CLEANING AND MAINTENANCE	12
PROBLEM SOLVING	15
SPECIFICATIONS	17

SAFETY INSTRUCTIONS

When using an electrical appliance, basic precautions should always be followed, including the following.

READ ALL INSTRUCTIONS BEFORE USING THIS VACUUM CLEANER

WARNING



Failure to follow the warnings and instructions may result in electric shock, fire and/or serious injury.

- Do not use outdoors.
- Do not handle charger, including charger plug, and charger terminals with wet hands.
- Prevent unintentional starting. Ensure the switch is in the off-position before picking up or carrying the appliance. Carrying the appliance with your finger on the switch or energizing appliance that has the switch on invites accidents.
- Do not touch nozzle when the vacuum cleaner is on.
- Do not put any object into openings. Do not use with any openings blocked; keep free of dust, lint, hair and anything that may reduce air flow.
- Do not operate the vacuum cleaner or charger if it has been damaged in any way. If vacuum cleaner is not working as it should, has been dropped, damaged, left outdoors, or dropped into water, call the **Eureka Customer Service HELPLINE at 1-800-282-2886.**
- To avoid excessive heat and damage to the unit or battery, the vacuum cleaner will not operate while charging.
- Do not allow to be used as a toy. Close attention is necessary when used by or near children.
- Use only as described in this manual. Use only manufacturer's recommended attachments.
- Recharge only with the charger specified by the manufacturer. A charger that is suitable for one type of battery pack may create a risk of fire when used with another battery pack.
- Do not pull or carry the charger by cord, use cord as a handle, close a door on cord, or pull cord around sharp edges or corners. Do not run appliance over cord. Keep cord away from heated surfaces.
- Do not use extension cords or outlets with inadequate current- carrying capacity for the charger.
- Do not unplug by pulling on cord. To unplug, grasp the plug, not the cord.
- DO NOT MUTILATE OR INCINERATE BATTERIES.
THEY BECOME DANGEROUS AT HIGH TEMPERATURES.

SAFETY INSTRUCTIONS

- Liquid ejected from the battery may cause irritation or burns. If the liquid gets on the skin, (1) seek medical attention, (2) wash quickly with soap and water, and (3) neutralize with a mild acid such as lemon juice or vinegar. If the liquid gets into the eyes, flush them immediately with clean water for a minimum of 10 minutes.
- When battery pack is not in use, keep it away from other metal objects, like paper clips, coins, keys, nails, screws or other small metal objects, that can make a connection from one terminal to another. Shorting the battery terminals together may cause burns or a fire.
- This product is functioning at temperature range within 40°F - 104°F.
- Do not use a battery pack or appliance that is damaged or modified. Damaged or modified batteries may exhibit unpredictable behavior resulting in fire, explosion or risk of injury.
- Do not expose a battery pack or appliance to fire or excessive temperature. Exposure to fire or temperature above 266°F may cause explosion.
- Follow all charging instructions and do not charge the battery pack or appliance outside of the temperature range specified in the instructions. Charging improperly or at temperatures outside of the specified range may damage the battery and increase the risk of fire.
- Have servicing performed by a qualified repair person using only identical replacement parts. This will ensure that the safety of the product is maintained.
- Do not modify or attempt to repair the appliance or the battery pack except as indicated in the instructions for use and care.
- The terminals on both the vacuum cleaner and battery should be kept free and clean of objects. Do not insert metal objects inside the terminals.
- This vacuum cleaner creates suction. Keep hair, loose clothing, fingers, and all parts of body away from openings and moving parts.
- Do not pick up anything that is burning or smoking, such as cigarettes, matches, or hot ashes.
- Do not use without filters in place.
- Use extra care when cleaning stairs.
- Do not use to pick up flammable or combustible liquids, such as gasoline, or use in areas where they may be present.

SAFETY INSTRUCTIONS

- Store vacuum cleaner and charger indoors in a cool, dry area.
To avoid electric shock and/or cleaner damage, do not expose to weather elements.
- Keep your work area well lit. Unplug electrical appliances before vacuuming them.
- Overcharging, short circuiting, reverse charging, mutilating or incinerating the cells and the batteries must be avoided.
- If a cell or a battery has leaked or vented, it should be replaced immediately using protective gloves.
- If and when necessary, these cells or batteries must be replaced with identical new ones from the same manufacturer.
If a cell or a battery to be replaced is connected with other cells or batteries in series, it is recommended that the other cells or batteries be replaced with new ones at the same time.
- Reverse polarity installation of the cell or the battery in the end product must be avoided.
- Do not incinerate this appliance even if it is severely damaged.
Contact local waste facility before discarding in trash.
- Always use Eureka cleaning solution in your machine, other cleaning solutions may damage the machine and void the warranty.
- Do not use an excessive amount of cleaning solution or it may cause internal damage to the machine.
- Do not immerse in liquid. Use only on surfaces moistened by the cleaning process.
- Use only on level surfaces for optimal cleaning results.
- Do not use to pick up toxic substances (solvents, ammonia, gasoline, chlorine bleach, acidic substances, drain cleaner, etc.).
- Do not lift, carry or shake appliance while in use.
- When in use do not lay the machine down flat or on its side to prevent the dirty water from flowing into the motor.

SAVE THESE INSTRUCTIONS

PRODUCT OVERVIEW

06

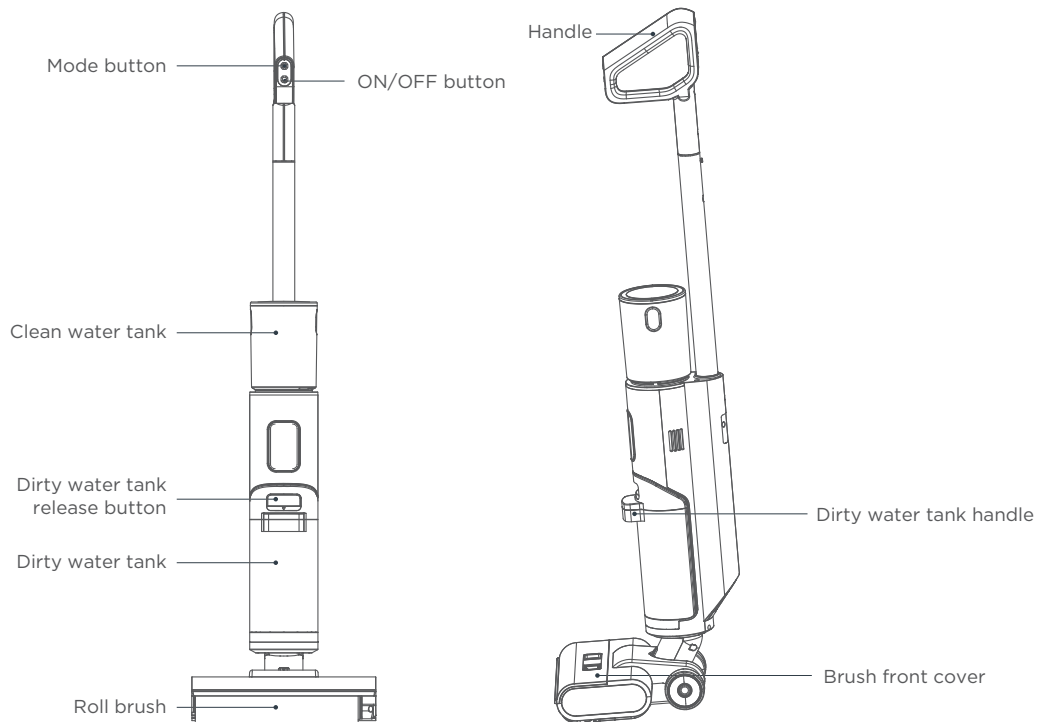

PRODUCT OVERVIEW

List of Accessories

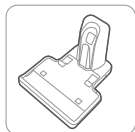

Charging/docking station x 1

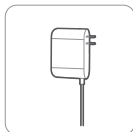

Adapter x 1



Cleaning brush x 1



Filter x 1

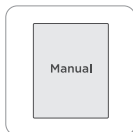

User's manual x 1



Cleaning solution x 1

Parts

Turbo mode

The water from the machine wets the roll brush, and the machine provides strong suction power to clean the floor.

Eco mode

The water from the machine wets the roll brush to clean the floor.

Dry mode

The machine only provides strong suction power to clean the floor, which sucks up dry waste and residual water from the floor.

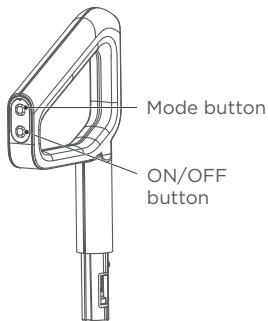

Self cleaning function: the battery indicator light displays a constant blue light.

Drying function: the battery indicator light is blinking blue for 30 seconds before turning off.

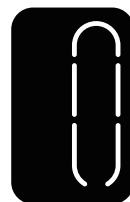
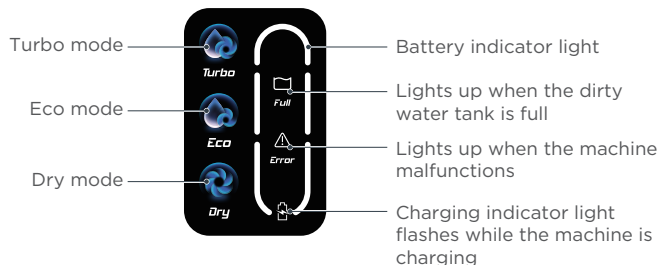

Self cleaning/
Drying Function



Full battery



Normal



Low battery

PRODUCT INSTALLATION

08

Handle Installation and Removal

Installation

Insert the end of the handle into the port of the main unit along the vertical direction until there is a click, which indicates the installation is successful;

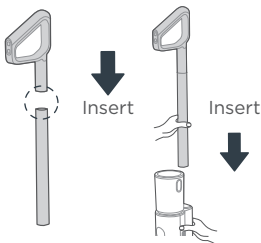

Removal

Insert a screwdriver or other tools into the hole, and pull out the handle upward.

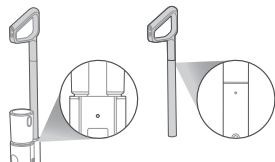

1. Insert the charging end of the charger into the rear port of the charging dock, and connect the plug to a 100V-240V power.
2. Put the machine upright into the charging/docking station, and make sure that the bottom of the body completely falls into the charging base. At this moment, a voice will prompt "start charging", and the indicator light flashes.
3. It takes about 3-4 hours to fully charge the machine. When the battery is fully charged, the indicator will turn off and the machine will automatically power off.

Charging Battery



WARNING

For the purposes of recharging the battery, only use the detachable supply unit provided with this appliance.



ATTENTION

Charge the product before the first use.

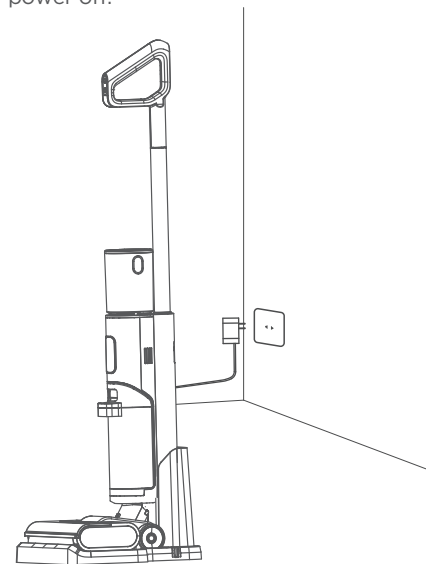

PRODUCT INSTALLATION



ATTENTION

Voice cannot be triggered when turned off.

4. When the machine is powered on for the first time, the voice function is turned on by default, which can be turned off by pressing the voice button, and be turned on by pressing this button again.



Filling Clean Water Tank



ATTENTION

Fill water only to the clean water tank.

- 01** | Hold the machine with one hand, grab the water tank with the other hand, rotate and remove the water tank.

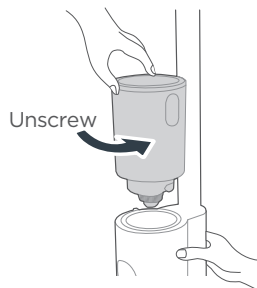

- 02** | Unscrew the water tank cover, pour tap water into the water tank, and add an appropriate amount of cleaning solution if desired.

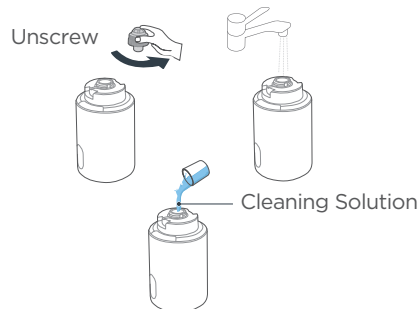

Note: Eureka cleaning solution only.

- 03** | Screw the water tank back into place on the machine, and when you hear a click sound, it means the installation is successful.

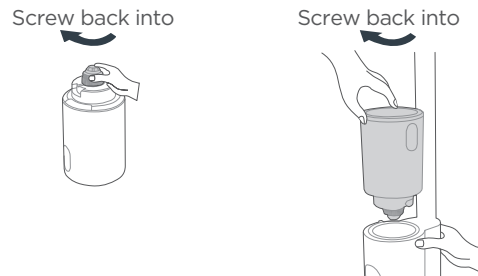

OPERATION INSTRUCTIONS

10

Turning On and Cleaning

- 01** | Step on the floor brush and pull the handle diagonally until you hear a click. The machine is now in standby mode.

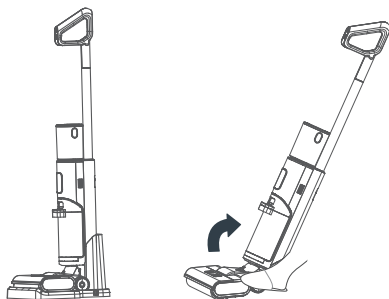

- 02** | To start working, press the ON/OFF button. Press this button again to stop the machine.

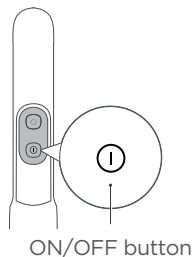

- 03** | The machine defaults to ECO mode when it starts. To switch to the Eco mode, press the mode switch button. Press this button again to switch to the Dry mode.

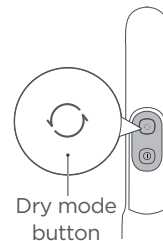

ATTENTION

After using the machine, it is recommended to place it vertically on the specially designed charging/storage base.

OPERATION INSTRUCTIONS

Upright Pause Function

In working state, you can step on the floor brush to erect the body, the machine will stop working and enter standby state; it will automatically turn off after 2 minutes of standby.

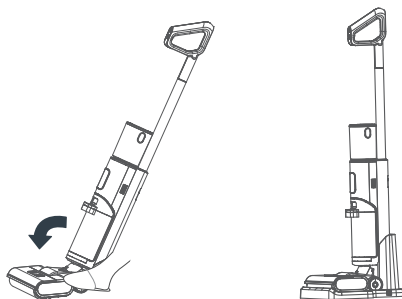

Self-cleaning + Drying Function



CAUTION

- After the self-drying is complete, it automatically enters the charging state. It is normal for the machine to indicate low battery after self-drying in a low battery state.
- In the self-drying mode, to improve the drying effect, the rolling brush will rotate every 2 minutes with a "drip" sound, which is a normal phenomenon.

1. When the machine is in charging state, short press the self-cleaning button to activate the self-cleaning and self-drying mode. During the self-drying process, the roll brush rotates for 30 seconds for centrifugal drying, followed by the low-speed operation of the fan for 3-5h to properly dry the roll brush and pipeline.
2. When the machine is in charging state, long press the mode switch button for 3 seconds to directly enter the self-drying mode.
3. To stop the self-cleaning or self-drying, press the self-cleaning button again.
4. After the self-cleaning is completed, please clean the dirty water tank in time. If there are residual stains on the base, please clean them in time.

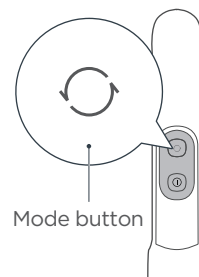

CLEANING AND MAINTENANCE

12

Waste Water Detect Alarm



ATTENTION

- After cleaning, it is recommended to place the machine upright in the charging base; do not place the machine in places with direct sunlight or moisture.
- In order not to affect the performance of the machine, it is recommended that you regularly maintain its parts.
- Before cleaning, please disconnect the power supply to stop the machine.
- Scrub with water or neutral detergent, wring out the cleaning cloth before scrubbing to avoid water leaking into the electrical components.

- 01** | Press the button of dirty water tank with your thumb and pull outward to remove the tank.

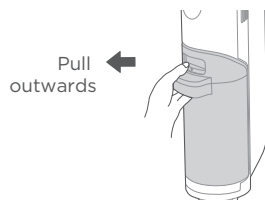

- 02** | Hold the tank with one hand and pull out the top cover of the tank with the other hand.

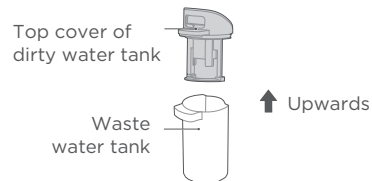

- 03** | Dump the sewage from the side of the dirty water tank and rinse it clean; remove the filter from the top cover of the dirty water tank, rinse it clean, and air-dry it.



- 04** | Install the dirty water tank back to the machine until there is a click sound; (when installing dirty water tank, it is recommended to hold the body with another hand to avoid tipping over).



CLEANING AND MAINTENANCE

Roll brush and Cover Cleaning



ATTENTION

- It is recommended to clean filter/roll brush after every use and replace after 3-6 months.
- If residual stains are found on the suction surface of the floor brush, wipe it with a wet cloth. Do not rinse it with water.

- 01** | Press the buckle as shown in the diagram to remove the floor brush cover.

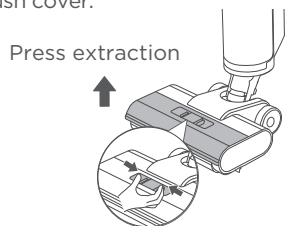

- 02** | Rotate the end cap knob as shown in the diagram and pull out the roll brush sideways.

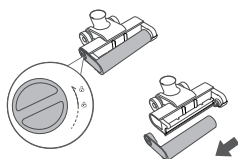

- a. Rotate the end cap knob b. Pull out the roller

- 03** | If there is still hair or other debris tangled on the roll brush after self-cleaning, remove the tangled debris from the roll brush; for heavy-duty cleaning (such as tomato sauce, soy sauce, etc.), if there is still dirt residue on the roll brush after self-cleaning, it can be self-cleaned again or the roll brush can be removed and cleaned with water.

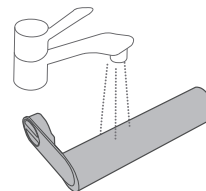

- 04** | If there is residual dirt on the roll brush cover after self-cleaning, rinse the roll brush cover with water.

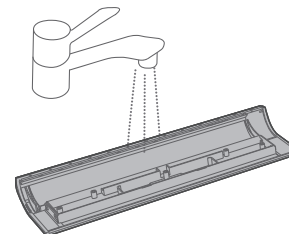

CLEANING AND MAINTENANCE

14

- 05** | If there are any residual stains on the suction nozzle (the part exposed after removing the roll brush) after self-cleaning, please wipe it with a damp cloth instead of washing it with water.

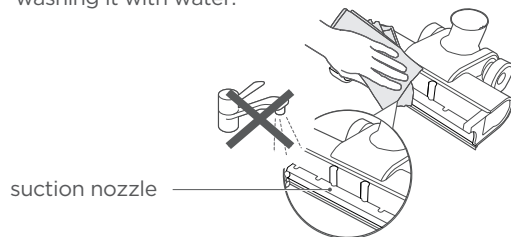

- 07** | After cleaning, cover the floor brush, align it with the installation hole, press it down, and you will hear a click when it is successfully installed.

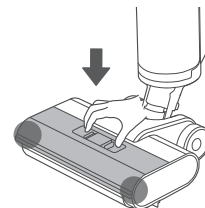

- 06** | After cleaning, reinstall the roll brush. If not in immediate use, you can place the roll brush in a ventilated area to dry before installation.

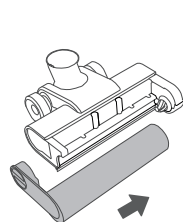

a. Reinstall the roller

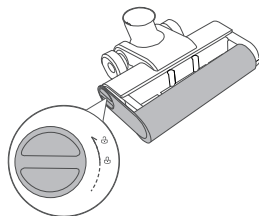

b. Screw the end cover button

PROBLEM SOLVING



Make sure vacuum is turned off and power cord is unplugged.

NOTICE: Thermal cut-off

This vacuum cleaner has a special thermostat that protects the vacuum in case of motor overheating. If the vacuum suddenly shuts off, proceed as follows: 1) Push the power switch to off and unplug the vacuum. 2) Check the vacuum for a possible source of overheating such as a full dirty water tank, blocked intake passage or clogged filter. If these conditions are found, fix them and wait at least 30 minutes before attempting to use the vacuum. 3) After the 30 minute period, plug the vacuum back in and turn on the switch.

Problem	Possible cause	Solution
Abnormal noise when machine is on	The nozzle is blocked	Clean up obstacles in the nozzle
	The clean water tank is empty	Add water to the clean water tank
	The clean water tank is not installed in place	Reinstall the clean water tank
Floor brush doesn't have water	The clean water tank is empty	Add water to the clean water tank
	The clean water tank is not installed in place	Reinstall the clean water tank
The roll brush isn't spinning	The roll brush is entangled with hair and other objects	Clean the roll brush
	The dirty water tank is full	Clean up the dirty water tank
	Low battery	Recharge the machine
	The pipe is blocked	Clean up the pipe under the waste water tank

PROBLEM SOLVING



Make sure vacuum is turned off and power cord is unplugged.

	Possible cause	Solution
Suction power is weakened	Roll brush, roll brush cover and waste water tank are not installed properly	Reinstall
	The roll brush is entangled with hair and other objects	Clean the roll brush
	The nozzle or pipe is blocked	Clean up obstacles in the nozzle
	Dirty water tank filter is dirty or missing	Clean or install in the nozzle
Water leaking from air outlet	The dirty water tank float is stuck	Empty tank and clean debris from the float, see P13
Water leaking from bottom of machine	Dirty water tank or filter isn't installed	Reinstall dirty water tank and filter, see P13

SPECIFICATIONS

Product Model	NEW430BL
Charging rated input	100-240V~ 50/60Hz
Charging output	27V --- 0.8A
Charging time	3-4h
Power	230W

Voltage	22.2V ---
Product Size	270x282x1120mm
Clean water tank volume	800mL
Dirty water tank MAX line volume	400mL

eureka
EASY.CLEAN.DONE.